

Extruded Aluminum Brackets

The **extruded aluminum brackets** have been designed to fit **glassed aluminum facades**. The optimal design of **the bracket enables a perfect transfer of all loads from the facades construction on to the main supporting structure of the building**. It also gives a very precise fitting of the facade with the possibility of regulation **in all three directions not using washers or additional distances**.

Strong points of extruded aluminum brackets:

- resistance to atmospheric factors
- light weight which has a considerable meaning with transportation costs
- versatility with additional cutting or drilling not requiring anti-corrosive protection
- no galvanic corrosion on contact with other aluminum facade elements
- optionally brackets can be delivered powder coated or anodized
- reduced delivery times, stocks available within 2-3 days

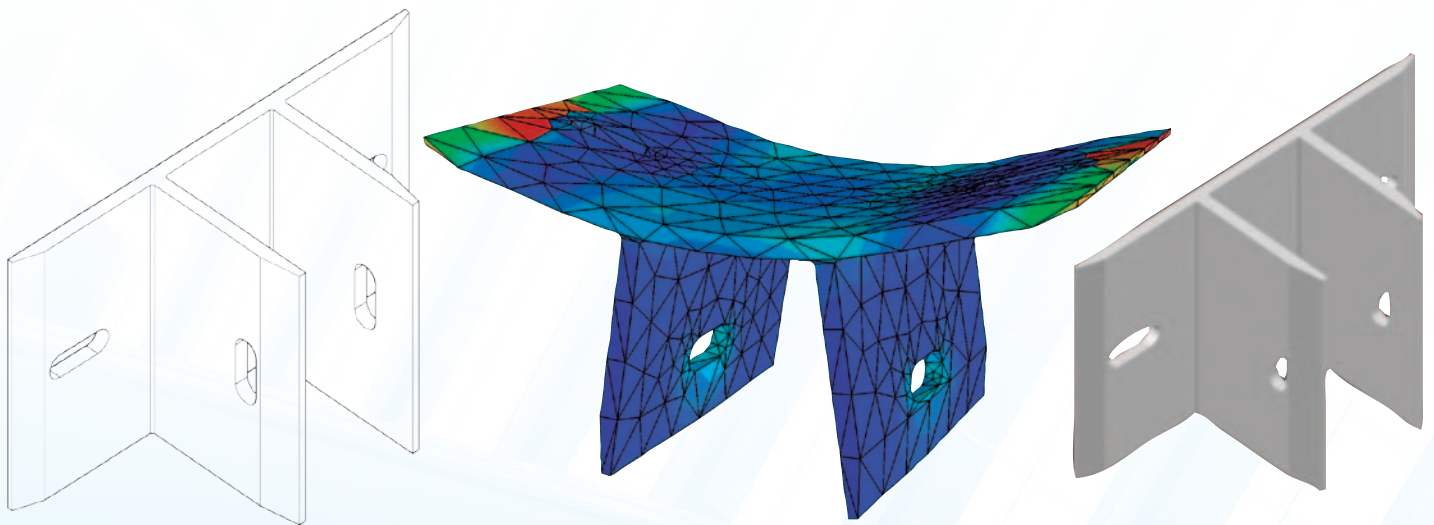

BSP BRACKET TYPE K1/A-B-FIX

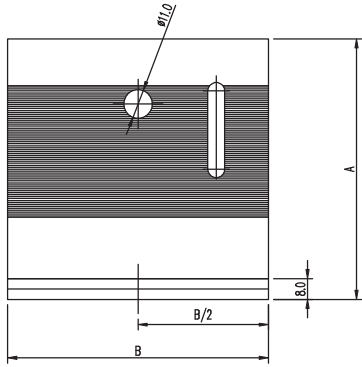
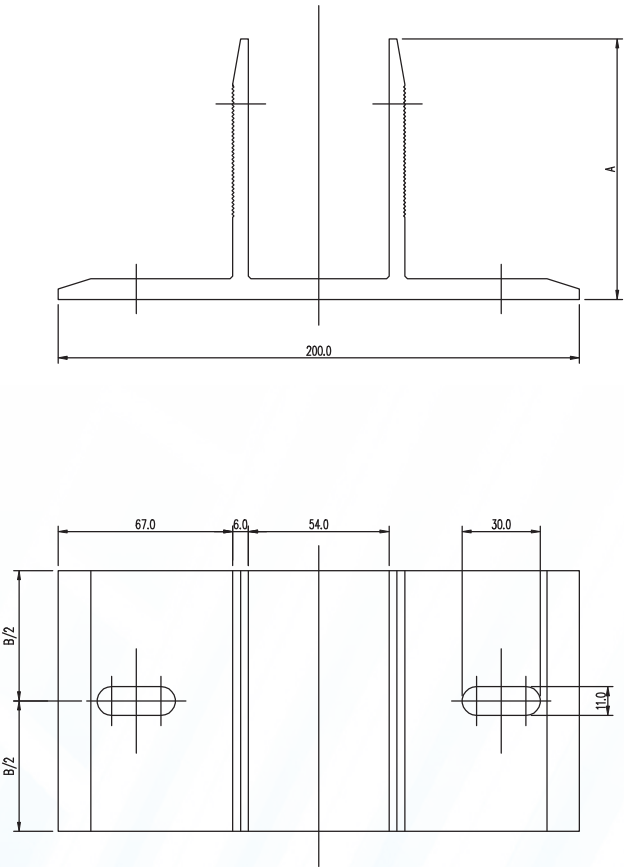

NAME OF BRACKET	A	B
BSP BRACKET TYPE K1/ 80-150-FIX	80	150
BSP BRACKET TYPE K1/ 80-120-FIX	80	120
BSP BRACKET TYPE K1/ 80-100-FIX	80	100
BSP BRACKET TYPE K1/ 80- 80-FIX	80	80
BSP BRACKET TYPE K1/100-150-FIX	100	150
BSP BRACKET TYPE K1/100-120-FIX	100	120
BSP BRACKET TYPE K1/100-100-FIX	100	100
BSP BRACKET TYPE K1/100- 80-FIX	100	80
BSP BRACKET TYPE K1/120-150-FIX	120	150
BSP BRACKET TYPE K1/120-120-FIX	120	120
BSP BRACKET TYPE K1/120-100-FIX	120	100
BSP BRACKET TYPE K1/120- 80-FIX	120	80

BSP BRACKET TYPE K1/A-B-LOS

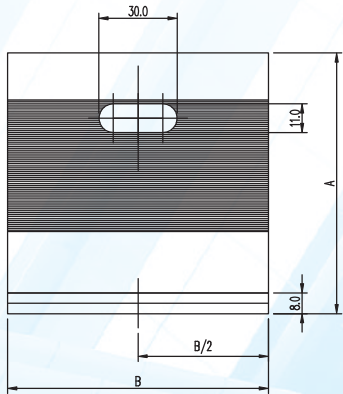
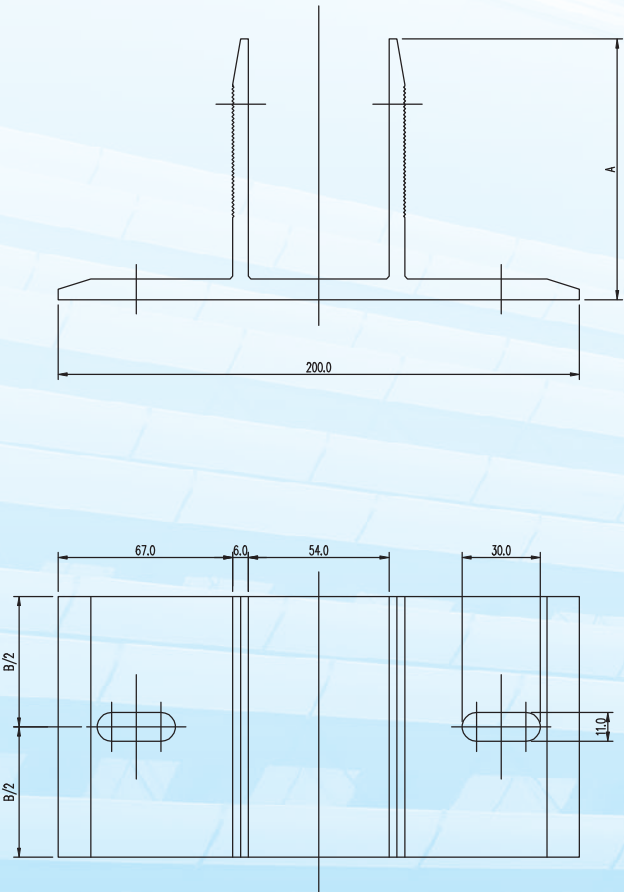

NAME OF BRACKET	A	B
BSP BRACKET TYPE K1/ 80-120-LOS	80	120
BSP BRACKET TYPE K1/ 80-100-LOS	80	100
BSP BRACKET TYPE K1/ 80- 80-LOS	80	80
BSP BRACKET TYPE K1/ 80- 60-LOS	80	60
BSP BRACKET TYPE K1/100-120-LOS	100	120
BSP BRACKET TYPE K1/100-100-LOS	100	100
BSP BRACKET TYPE K1/100- 80-LOS	100	80
BSP BRACKET TYPE K1/100- 60-LOS	100	60
BSP BRACKET TYPE K1/120-120-LOS	120	120
BSP BRACKET TYPE K1/120-100-LOS	120	100
BSP BRACKET TYPE K1/120- 80-LOS	120	80
BSP BRACKET TYPE K1/120- 60-LOS	120	60

BSP BRACKET TYPE K2/A-B-FIX

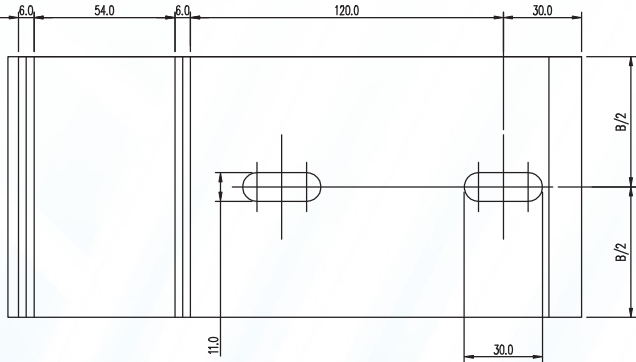
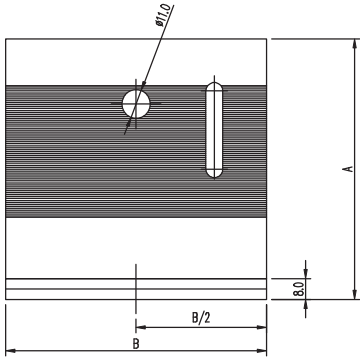
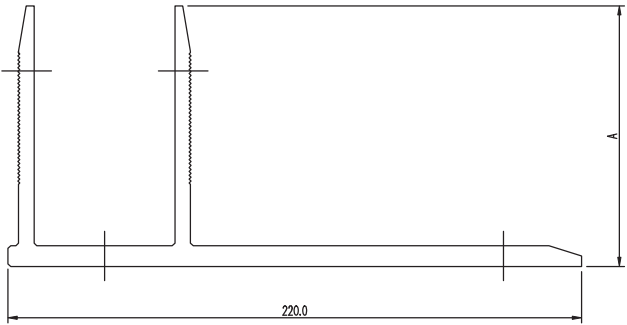

NAME OF BRACKET	A	B
BSP BRACKET TYPE K2/ 80-150-FIX	80	150
BSP BRACKET TYPE K2/ 80-120-FIX	80	120
BSP BRACKET TYPE K2/ 80-100-FIX	80	100
BSP BRACKET TYPE K2/ 80- 80-FIX	80	80
BSP BRACKET TYPE K2/100-150-FIX	100	150
BSP BRACKET TYPE K2/100-120-FIX	100	120
BSP BRACKET TYPE K2/100-100-FIX	100	100
BSP BRACKET TYPE K2/100- 80-FIX	100	80
BSP BRACKET TYPE K2/120-150-FIX	120	150
BSP BRACKET TYPE K2/120-120-FIX	120	120
BSP BRACKET TYPE K2/120-100-FIX	120	100
BSP BRACKET TYPE K2/120- 80-FIX	120	80

BSP BRACKET TYPE K2/A-B-LOS

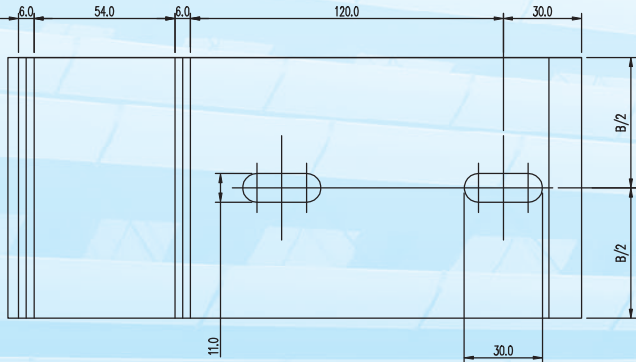
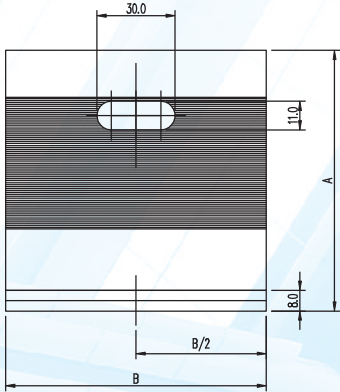
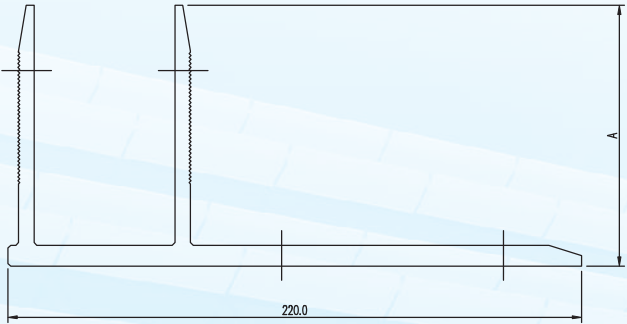

NAME OF BRACKET	A	B
BSP BRACKET TYPE K2/ 80-120-LOS	80	120
BSP BRACKET TYPE K2/ 80-100-LOS	80	100
BSP BRACKET TYPE K2/ 80- 80-LOS	80	80
BSP BRACKET TYPE K2/100-120-LOS	100	120
BSP BRACKET TYPE K2/100-100-LOS	100	100
BSP BRACKET TYPE K2/100- 80-LOS	100	80
BSP BRACKET TYPE K2/120-120-LOS	120	120
BSP BRACKET TYPE K2/120-100-LOS	120	100
BSP BRACKET TYPE K2/120- 80-LOS	120	80

EXAMPLE OF USE OF BSP EXTRUDED ALUMINIUM BRACKETS

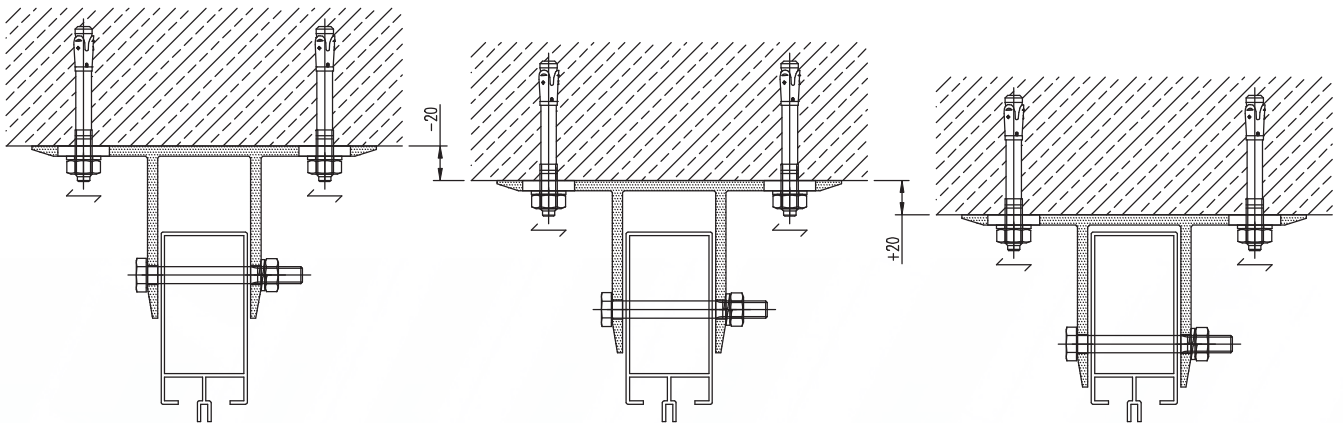

Range of regulation helps avoid problems with the tolerance of wall construction ± 2 cm

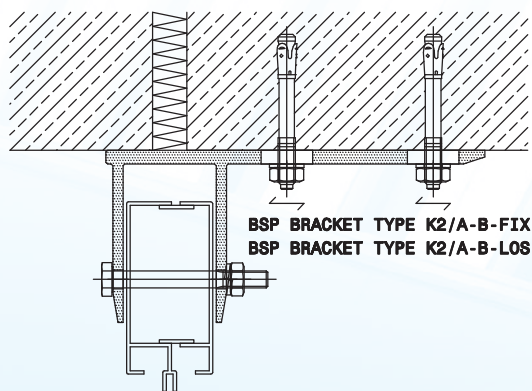

Side bracket within wall dilatation gap and...

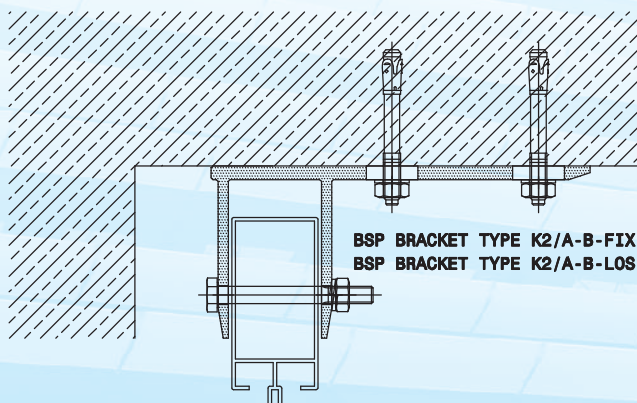

BSP BRACKET TYPE K2/A-B-FIX
BSP BRACKET TYPE K2/A-B-LOS

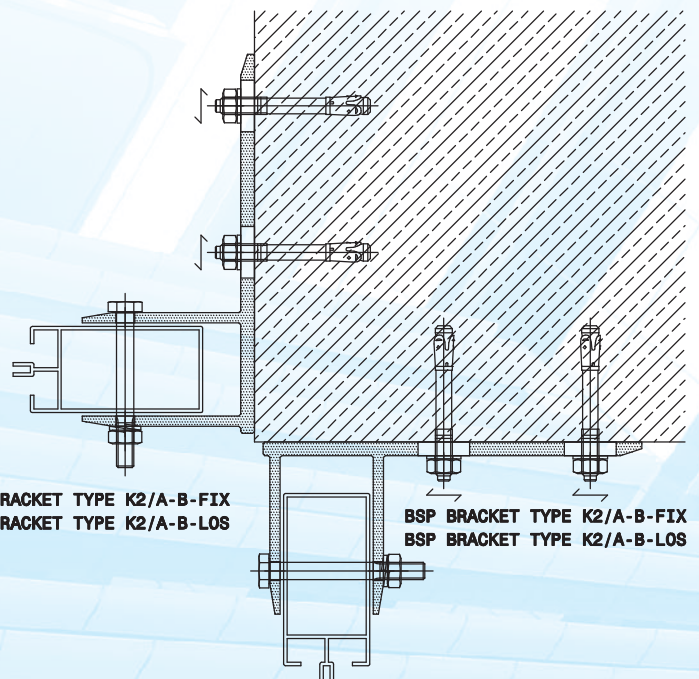

BSP BRACKET TYPE K2/A-B-FIX
BSP BRACKET TYPE K2/A-B-LOS

...within places where standard brackets cannot fit e.g. corners.